

GENERAL ARCHITECTURAL NOTES

1. ELEVATION 100'-0" SHOWN IN DRAWINGS ARE FOR REFERENCE ONLY. SEE CIVIL DRAWINGS FOR ACTUAL ELEVATIONS.
2. FLOOR PLANS, SECTIONS AND DETAILS NORMALLY SHOW THE FINISH FLOOR ELEVATIONS AS TOP OF CONCRETE SLAB.
3. FOR PIPE OPENINGS, DUCTWORK AND CONDUIT NOT SHOWN ON ARCHITECTURAL DRAWINGS SEE STRUCTURAL MECHANICAL AND ELECTRICAL DRAWINGS.
4. ALL MATERIALS AND WORKMANSHIP SHALL COMPLY WITH PROJECT SPECIFICATIONS.
5. WHERE LINTELS OVER OPENINGS ARE NOT DETAILED, 8" BOND BEAM UNITS OF THICKNESS EQUAL TO THE WALL SHALL BE USED, FOR A MAXIMUM OPENING SPAN OF SEVEN FEET. REINF. BOND BM. WITH 2-#4 BARS TOP AND BOTTOM.
6. WHERE PARTITIONS EXTEND TO ROOF DECK ABOVE AND BEAMS RUN PERPENDICULAR TO PARTITION, 1/4 INCH CLEARANCE SHALL PROVIDED AT ALL POINTS BETWEEN PARTITION AND MEMBER. THE 1/4 INCH OPENING SHALL BE CAULKED.
7. SILL FLASHING SHALL EXTEND 4 INCHES BEYOND EACH JAMB INTO MASONRY.
8. THE CONTRACTOR SHALL PROVIDE ADEQUATE TEMPORARY BRACING FOR ALL MASONRY WALLS DURING CONSTRUCTION.
9. ALL JOINT REINFORCING SHALL BE DISCONTINUOUS ACROSS CONTROL JOINTS IN MASONRY.
10. THE 12" CAVITY WALL, UNLESS NOTED OTHERWISE, SHALL BE REINFORCED AS FOLLOWS.

II. REQUIREMENTS FOR WALL STIFFENERS:

- A. THE CONTRACTOR SHALL PLACE WALL STIFFENERS ADJACENT TO DOOR WINDOW AND LOUVER OPENINGS AND AT ALL OTHER LOCATIONS INDICATED ON THE DRAWINGS.
- B. REINFORCING BARS IN THE WALL STIFFENERS SHALL BE WELD ONE QUARTER INCH CLEAR FROM THE OUTSIDE FACE SHELL WHILE THE GROUT FILL IS BEING PLACED. BLOCK SHALL BE FORMED WITH FACE SHELLS SUFFICIENTLY THICKER AT THE BOTTOM THAN AT THE TOP SO THAT BARS MAY BE PLACED AGAINST THE CELL WALLS AND STILL HAVE OVER ONE QUARTER INCH AVERAGE CLEARANCE. IN CONSTRUCTION WHERE ACCESS FROM THE TOP IS POSSIBLE, THE WALL SHALL BELAID UP TO ABOUT 8 FEET IN HEIGHT, WITH CLEAROUT HOLES* LEFT AT THE BOTTOM OF THE CELLS TO BE REINFORCED. THEN THE CELLS SHALL BE CLEANED OUT AND THE REINFORCING INSERTED FROM THE TOP AND POSITIONED FROM THE TOP AND THE BOTTOM ACCESS HOLE, WHERE ACCESS FROM THE TOP IS IMPOSSIBLE, THE STEEL SHALL BE POSITIONED AND OPEN END BLOCK (BLOCK WITH ONE END WEB REMOVED EITHER IN MANUFACTURE OR BY CUTTING) SHOVED SIDEWAYS INTO POSITION. THIS METHOD REQUIRES MORE GROUT THAN THE FIRST METHOD.

NOTES CONTINUED ON SHEET 'A-2'

	DATE	DESCRIPTION	MADE	APPRO
15-18-82		REVIEWED "AS BUILT" CONDITIONS - NO STRUCTURAL CHANGES OK. (GAP)		
5-1-78		REVISED TO SHOW "AS-BUILT" CONDITIONS.		
P-3	7-1-76	Added Note #3 SH. A-7		
1	3-1-75	AM 10002 GENERAL REVISIONS		

HAMM & KESSLER, INC. PROFESSIONAL ENGINEERS 7415 N. MYRATH RD. MILWAUKEE WIS. 53212		U. S. ARMY ENGINEER DISTRICT OMAHA CORPS OF ENGINEERS OMAHA, NEBRASKA		REVISIONS	
DESIGNED BY: RCH	DRAWN BY: R.M.	CHECKED BY: RCH	SUBMITTED BY: R.C. Hanson	GENERAL BILLY MITCHELL FIELD AGE SHOP WISCONSIN	
APPROVED: <i>William J. Hansen</i> REGIONAL ENGINEER DISTRICT SOUTH BRANCH				DATE: FEBRUARY 1975 75 MCAER ADV. P. 218-712	
APPROVER: <i>Donald F. Glan</i> COL. D. E. DISTRICT ENGINEER				SCALE: AS SHOWN	SPEED NO. DADA 45 DRAWING NUMBER 75 B 0119 AW 35-32-02 (3)
SHEET A-1					

DRAWER NO. 11	NO. 3021	RECOR	219-011	Fp
---------------	----------	-------	---------	----

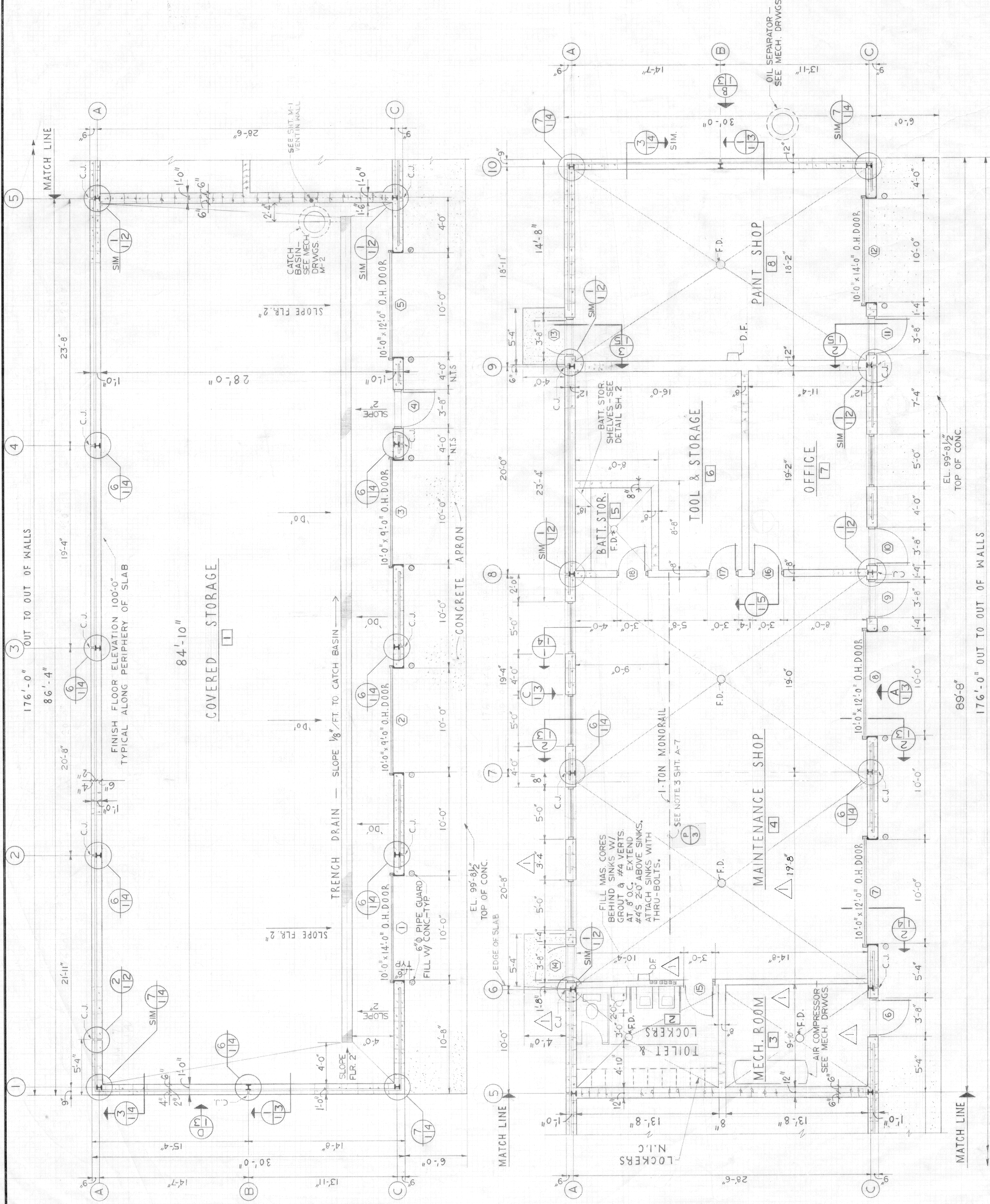

GROSS AREA = 5280 SQ. FT.

NORTH

FLOOR PLAN

FIN. FL. EL. 100' 0" @ HIGH PT. SCALE 1/4" = 1'-0"

'C.J.' ON PLAN AND ELEVATIONS INDICATES CONTROL JOINT IN C.M.U. CAVITY WALL AND CONC. FDN. WALL.

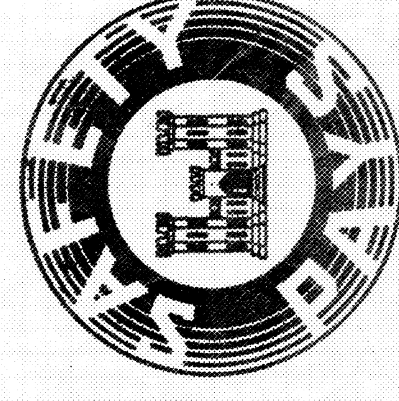

THIS PLAN ACCOMPANIES CONTRACT NO. 04C6045 75 C 0217 MODIFICATION NO.

DRAWER No. ~~12~~ 11 No. ~~22~~ 21 RECOR